

# cura<sup>1</sup>

## 3508 - LED Pager



### What's in the box?



2703 Wireless Output Falls Monitor



2 X AA Batteries



QuickStart User Guide

### Compatible & Optional Accessories

2719 & 2720 Cordless Pad / Mat Transmitters & all pads & mats that use them, 2406 Plug Pack 6Vdc, 2558 Wireless Waterproof Call Button with Pull Cord, 2588 Personal Emergency Transmitter (PET), 2721 iBeam, 3502 Wireless Handset, 3504 Mounting Bracket, 2552 DoorAlert Door Strip, 2558 Wireless Call Button with Pull Cord, 2573 Wristband Duress Transmitter, 2721 iBeam, 3502 Wireless Handset, 3503 Wireless Magnetic Door Switch, 3504 Mounting Bracket

**cura<sup>1</sup>**

10 Gray Street, Kilkenny South Australia 5009  
www.cura1.com

 **1300-12-CARE (2273)**

UM-046b



All our products are supplied with a full warranty and are guaranteed to be free from defects in material and workmanship.

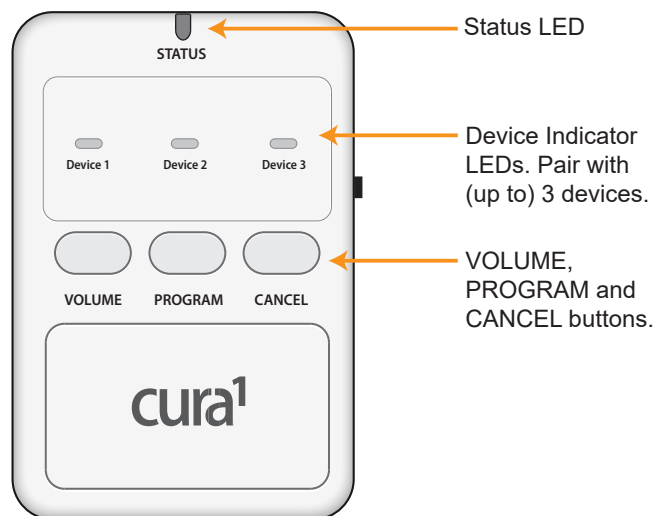

Status LED

Device Indicator LEDs. Pair with (up to) 3 devices.

VOLUME, PROGRAM and CANCEL buttons.

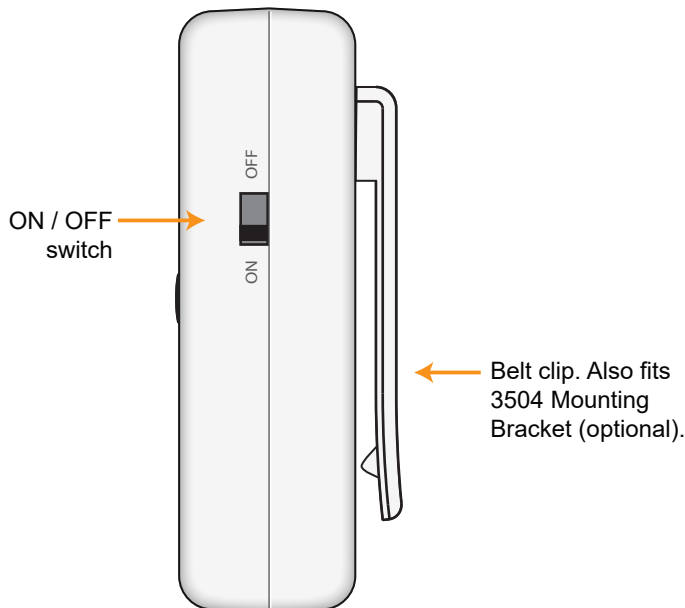

ON / OFF switch

Belt clip. Also fits 3504 Mounting Bracket (optional).

## Usage instructions

### Setting Alarm Tone

There are 3 tones that can be selected. Press the VOLUME button to toggle between these options:

1. Low tone with vibration alert.
2. Silent but with vibration alert.
3. High tone with vibration alert.

### Alarms & Reset

**When the alarm condition is active** the pager will vibrate and produce a continuous alarm tone (depending on your VOLUME settings). The device indicator LEDs will indicate which device has the alarm condition and the Status LED will blink red every 7 seconds until the pager is reset.

**To stop (reset) the alarm**, press and hold the **CANCEL** button for ~1 second.

### Low Battery

Status LED flashes red.

*\*The range of wireless devices may vary and be dependent on your specific environmental conditions.*

*cura<sup>1</sup> products are designed to augment well designed care programs & practices, cura<sup>1</sup> does not claim that any of its products are suitable as a substitute, or as a total solution for individuals that require care and constant supervision & are at risk.*

# QUICK START GUIDE

3508 - ActiveCare LED Pager Quick setup for use with cura<sup>1</sup> cordless pads, mats and call buttons.

## Step 1

### Insert 2 x AA Alkaline Batteries

Use a Phillips screwdriver to open the battery compartment and insert two new AA alkaline batteries.

Replace cover and secure the screw.

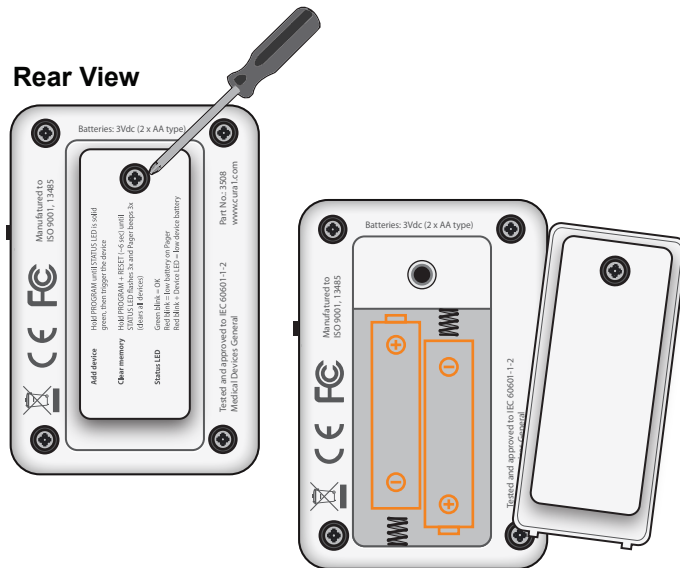

## Step 2

### Clear the Pager memory

If the Pager has previously been programmed, there may not be any memory slots left so it will be necessary to clear the Pager's memory before trying to program a new device into a memory slot. To Clear the Pager Memory:

1. Hold down PROGRAM and CANCEL together for ~ 6 seconds. There will be 3 short beeps and the status light will flash 3 times when the memory is cleared.

## Step 3

### Enter Programming Mode

1. Ensure the pager ON / OFF selector switch is in the ON position.
2. Press and hold the **PROGRAM** button until the status LED turns solid green.
3. Release the **PROGRAM** button.

Note: the pager will automatically exit Programming Mode after successfully pairing or after 30 seconds.

## Step 4

### Pair with up to 3 Devices

1. While the 3508 LED Pager is in Programming Mode (Step 3) trigger the first device. "Device 1" LED will flash twice to acknowledge successful pairing.
2. For the second device, enter Programming Mode again (Step 3) then trigger the second device. "Device 2" LED will flash twice to acknowledge successful pairing.
3. For the third device, enter Programming Mode again (Step 3) then trigger the third device. "Device 3" LED will flash twice to acknowledge successful pairing.

**Note** - for pairing with a 2719 Pad / Mat Transmitter, you do not need to create an alarm condition in the Pad / Mat. To pair with a 2719 Transmitter simply turn the Transmitter from OFF to ON when the pager is in Programming Mode.

## Step 5

### Test the pager prior to each use

Trigger the monitored device (cordless pad, mat, call button or other compatible device).

The pager should vibrate / sound alarm.

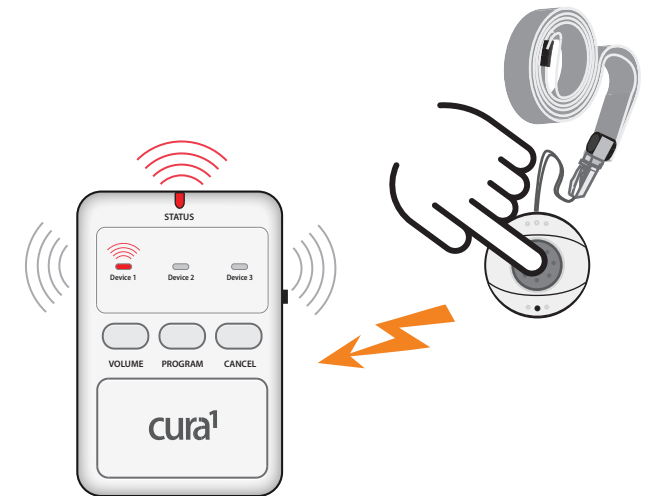

**To reset the Pager** after an alarm, press and hold the **CANCEL** button for ~1 second.

**IMPORTANT: Test the operating range** within your building or work environment. Have someone repeatedly trigger the device while you walk around the building. Note any areas where the signal reception might be poor.